

NOTE: DO NOT DISCARD the Parts List from the Instruction Bulletin. Place the Parts List in the appropriate place in the machine manual for future reference. Retaining the Parts List will make it easier to reorder individual parts and will save the cost of ordering an entire kit.

NOTE: Numbers in parenthesis () are reference numbers for parts listed in Bill of Materials.

Installation instructions for **kit number 9008069**

SYNOPSIS:

This kit contains the parts needed to install the front light kit on T16 scrubbers.
Please follow step-by-step instructions.

SPECIAL TOOLS / CONSIDERATIONS: NONE

(Estimated time to complete: 1 hour)

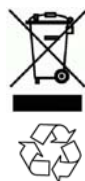

PROTECT THE ENVIRONMENT

Please dispose of packaging materials, used machine components such as batteries and fluids in an environmentally safe way according to local waste disposal regulations.

Always remember to recycle.

PREPARATION:

1. Park the machine on a clean level surface, turn off the machine, and remove the key.

FOR SAFETY: Before leaving or servicing machine, stop on level surface, turn off machine, and remove key.

2. Disconnect the battery cable from the machine.



WARNING: Always disconnect battery cables from machine before working on electrical components.

INSTALLATION:

1. Remove the head headlight disk and grommet from the front shroud. Set the grommet aside. Discard the headlight disk. (Fig. 1)

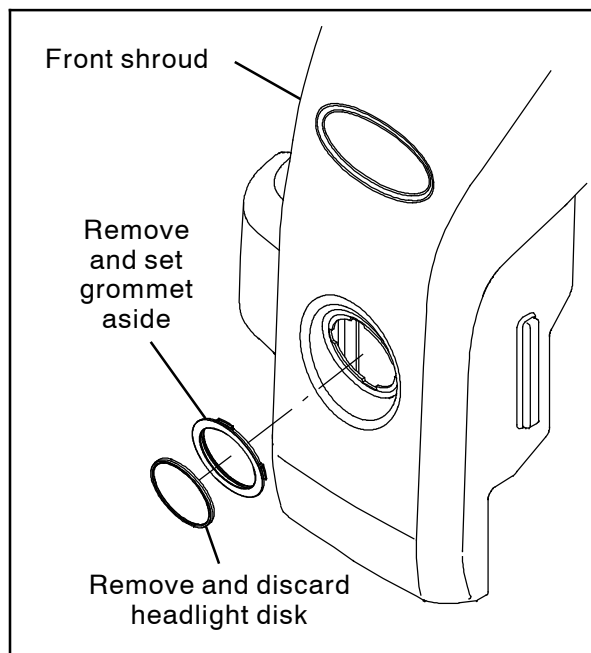

FIG. 1

2. Install the grommet removed from the front shroud in the previous step onto the headlight. (Fig. 3)

NOTE: If necessary, use soapy water to help make installing the grommet onto the headlight (1) easier.

3. Pull the main wire harness headlight connector out through the hole in the front of the front shroud and connect the headlight connector to the headlight (1). (Fig. 3 / Fig. 4 / Fig. 5)
4. Install the headlight assembly (1) into the front shroud. (Fig. 3)

NOTE: Do not complete Step 5 through Step 10 and proceed to Step 11 if the machine is equipped with a reverse light / backup alarm. The light switch is already properly wired for the front headlight if the machine is equipped with the reverse light / backup alarm option.

5. Remove the hardware holding the left console panel to the front shroud and set the hardware aside. (Fig. 3)
6. Carefully pull the left console panel from the front shroud. Take care to not break any wire connections when pulling the panel from the shroud. (Fig. 3)
7. Remove the hole plug from the left console panel and discard the plug. (Fig. 3)
8. Insert the switch (4) into the left console panel. (Fig. 3)
9. Connect the main wire harness to the switch (4). (Fig. 3 / Fig. 4 / Fig. 5)
10. Reinstall the left console panel onto the front shroud. (Fig. 3)
11. Remove the hardware holding the electrical panel to the front shroud. Set the hardware aside. (Fig. 3)

12. Carefully pull the electrical panel from the front shroud. Take care to not break any wire connections when pulling the panel from the shroud. (Fig. 3)

13. Insert the 2.5- Amp circuit breaker (3) into the electrical panel (CB12). (Fig. 2 / Fig. 3)

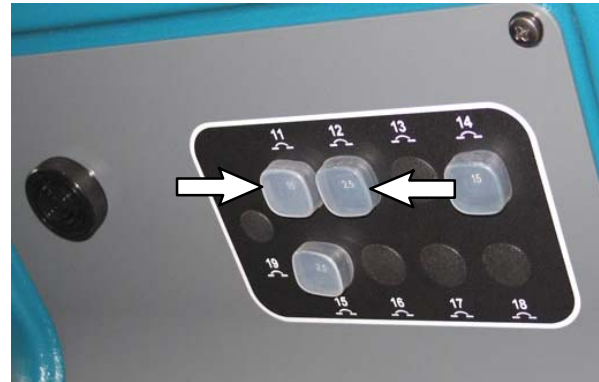

FIG. 2

14. Insert the 15- Amp circuit breaker (5) into the electrical panel (CB11). (Fig. 2 / Fig. 3)
15. Install a circuit breaker boot (2) onto the 2.5- Amp circuit breaker (3) and 15- Amp circuit breaker (5). (Fig. 2 / Fig. 3)
16. Connect the main wire harness to the 2.5- Amp circuit breaker (3) and 15- Amp circuit breaker (5). (Fig. 3 / Fig. 4 / Fig. 5)
17. Reinstall the electrical panel onto the front shroud. (Fig. 3)
18. Reconnect the battery cable to the machine.
19. Start and test the machine. Turn on the light switch and check the headlight to ensure it functions.

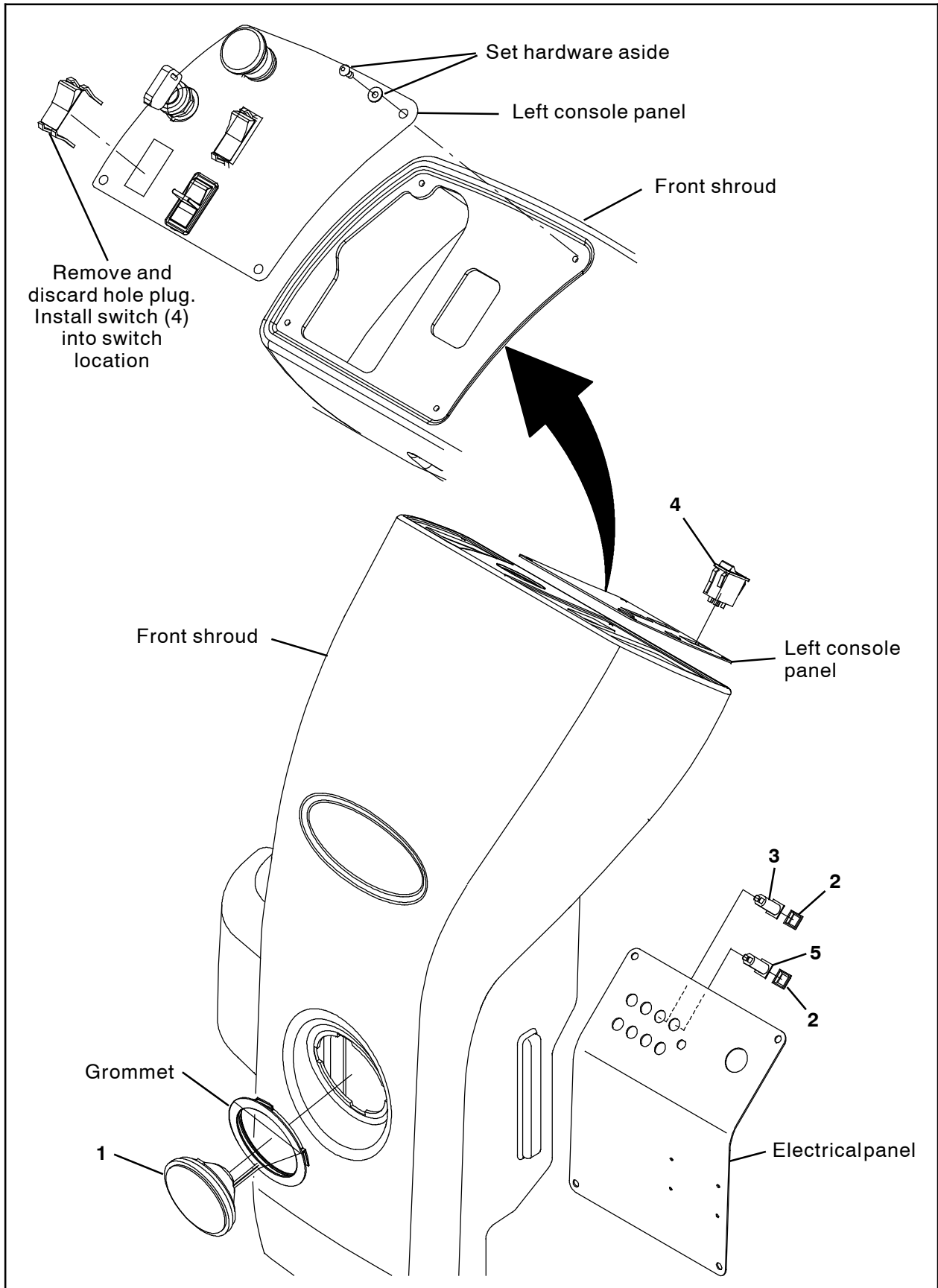

FIG. 3

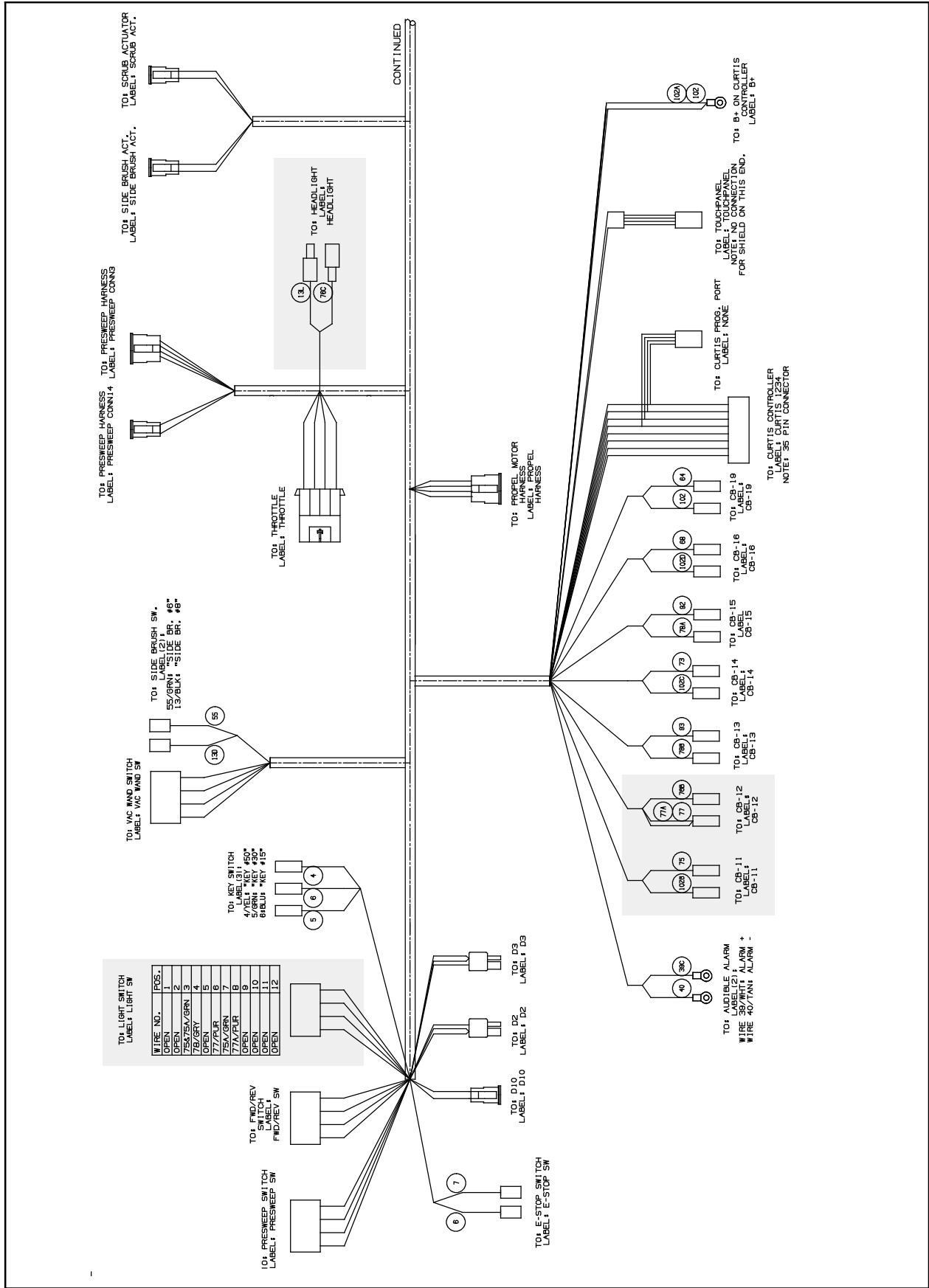

FIG. 4

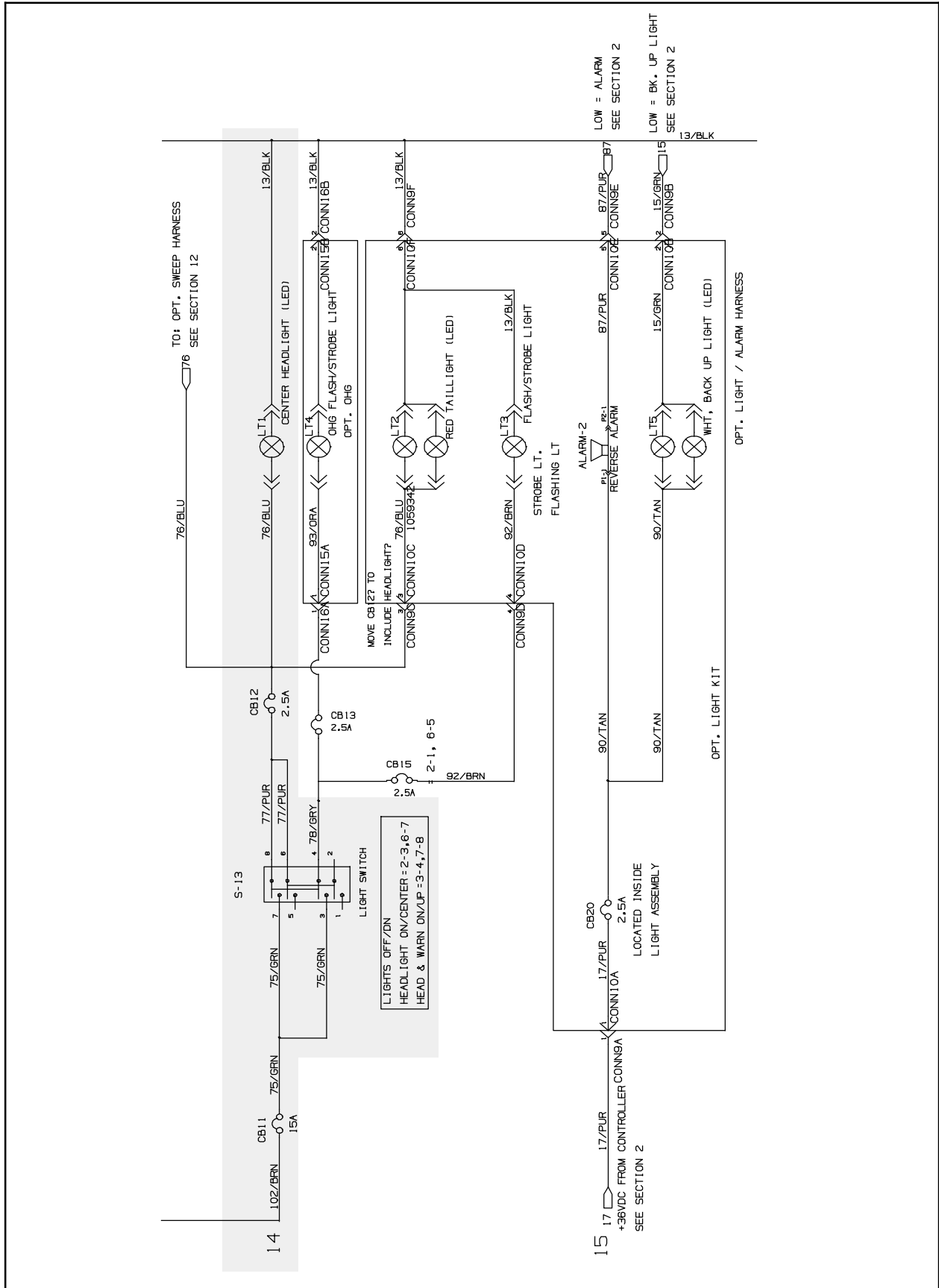

FIG. 5

Bill Of Materials For Light Kit, Front, CI [T16] - 9008069

	Ref.	Tennant Part No.	Description	Qty.
▽		9008069	Light Kit, Front, CI [T16]	1
▲	1	1048096	Headlight, 36VDC, LED, UL	1
▲	2	1064191	Boot, Circuit Breaker	2
▲	3	1064184	Circuit Breaker, 02.5a, Resettable	1
▲	4	377084	Switch, Rocker, Prgrsv	1
▲	5	1064188	Circuit Breaker, 15.0a, Resettable	1

TENNANT COMPANY
P. O. Box 1452
Minneapolis, MN 55440-1452